



VENTEC LAM

ROOF AND FACADE VENT

IDEAL FOR: STAIRWELLS AND SMOKE SHAFTS

24 HR NEXT DAY DESPATCH
400 SERIES COMPATIBLE
24 VOLT



Natural Smoke Ventilator

The Ventec LAM is an automatic multi-bladed smoke exhaust louvre designed with the primary function of dispersing smoke, fumes, and heat from inside buildings to the outside. It comes in a standard size allowing 1m² Geometric Free Area, but can also be manufactured to deliver up to 9.5m² of natural ventilation. It is fitted with a 24v actuator and is BS EN12101-2 certified. The standard LAM is supplied with an aluminium wind deflector.

Each unit is supplied preassembled. Flange options are available enabling installation on various types of roofing and facades. For vertical facade mounting a rain shield or structural canopy is recommended.



STANDARD SIZE – IN STOCK			
Structural Opening Width x Length (mm)	GFA (m ²)	Aa (m ²)	Current (amps)
1200mm x 1400mm	1.26	1.06	0.8
FOR NON-STANDARD SIZES PLEASE CALL OUR CUSTOMER CARE TEAM ON 01706 507 888			

Dimensions (standard size)

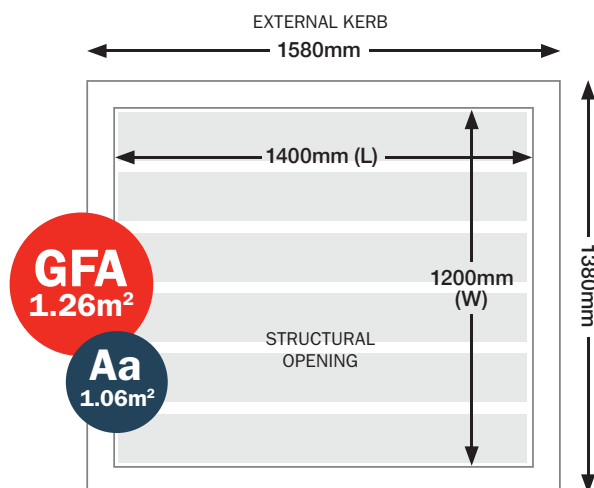

Nominal Sizes Available

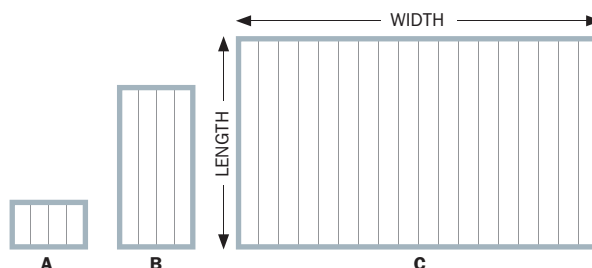

A	Minimum nominal size	800mm (W) x 500mm (H)
B	Maximum nominal size – Max. length at Min. width	800mm (W) x 1700mm (H)
C	Maximum nominal size – Max. length at Max. width	3800mm (W) x 2200mm (H)

* Smaller and larger sizes are available, but they may not be compliant with BS EN12101 UK Smoke Standards.

VENTEC LAM ROOF AND FACADE VENT



Technical Data

	STANDARD SIZE
Structural Opening Dimensions	1200mm (W) x 1400mm (L)
Certification	BS EN12101-2
Voltage	24v DC
Current Consumption	0.8 amps
Number Of Blades	6
Snow Load	SL 250
Wind Load	WL 1500
Operating Temperature Low	Resistance to -25°C or 0°C
Resistance Temperature High	B300 resistance to 300°
Vent Fire Class	E
Operational Reliability	Re300
Dual Purpose Reliability	Re10000
Opening Time	< 60 seconds
Base Material	2mm aluminium
Base Height	150mm
Height Total	550mm
Weight	46 Kg
FP Core Type	FP PLUS
Number Of Cores	2-Core + Earth

Blade Options*

- The standard blade material for the Ventec LAM is aluminium.



STANDARD BLADE 1.25mm Aluminium
NON-STANDARD BLADE OPTIONS
Aluminium + XPS Insulation
Clear Polycarbonate 16mm
Opal Polycarbonate 25mm
Clear Polycarbonate 25mm
Opal Polycarbonate 25mm

*Blade material may affect technical data stated

Number of blades at standard blade width	
Structural opening width (mm)	No. of blades
800mm	4
1200mm	6
1600mm	8
2000mm	10
3000mm	15
3600mm	18

Blade Orientation*



0°-45°

VERTICAL BLADE ORIENTATION



45°-90°

HORIZONTAL BLADE ORIENTATION

*Angle of installation may affect technical data stated

Thermal Performance

U-values of up to 1.2 W/m²K are achievable depending on size and options of product.

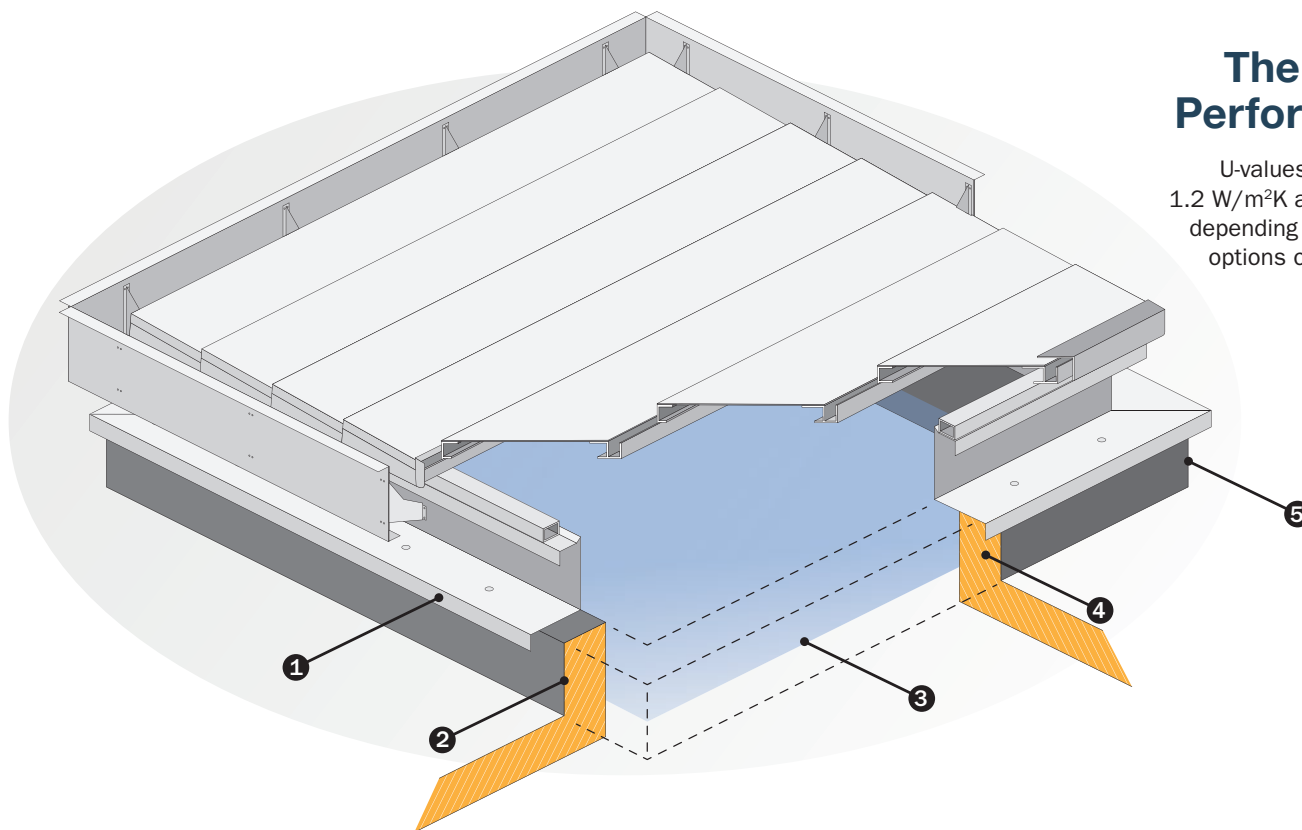

STANDARD SIZE	1. Flange outer (mm)	2. External upstand size (mm)	3. Structural opening (mm)	4. Upstand width	5. Upstand height
1.26m ² GFA / 1.06m ² Aa	1400mm x 1600mm	1380mm x 1580mm	1200mm x 1400mm	Maximum 90mm	Minimum 150mm

VENTEC LAM ROOF AND FACADE VENT

Uprand Requirements

A 90mm wide all round, weather resistant, finished upstand is required to accommodate the unit.



The required dimensions to achieve 1m² of Geometric Free Area are:
1200mm (W) x 1400mm (L) – Internal dimensions of structural opening
1380mm (W) x 1580mm (L) – External dimensions of finished upstand
1400mm (W) x 1600mm (L) – Overall dimensions of unit

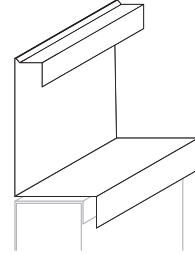

Flange Details

100mm N type overlay flange with a 30mm drip cap to be installed on a finished upstand.

Custom flange widths are available from 70mm to 320mm.

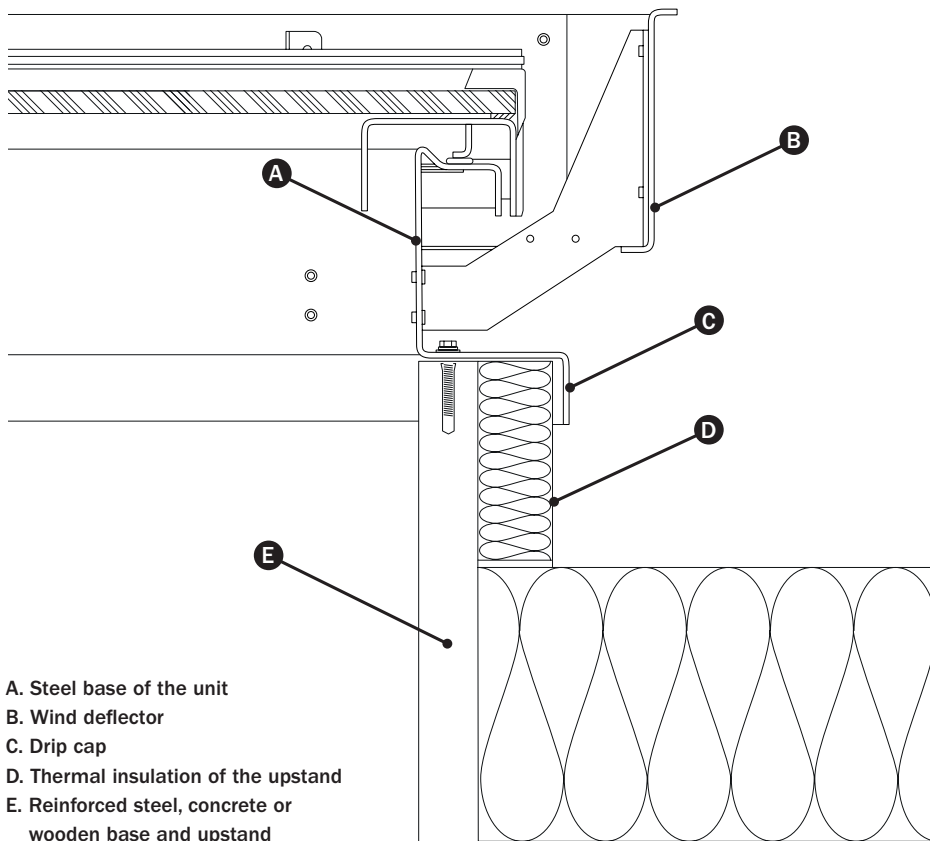

- A. Steel base of the unit
- B. Wind deflector
- C. Drip cap
- D. Thermal insulation of the upstand
- E. Reinforced steel, concrete or wooden base and upstand

INDICATIVE ONLY

Maintenance

It is important to maintain this product as per the manufacturers instructions. If you require assistance with any aspect of installation, commissioning or maintenance please contact our customer support care today.

Related Products and Services

The following should also be considered when planning your system.



INSTALLATION
& MAINTENANCE



PROJECT
COMMISSIONING

