



✓ **SMOKE**
VENTILATION

✓ **MONO**
ASSIST OPTION

✓ **CAR PARK**
VENTILATION

About This Product

In the event of fire, the Ventec 2000-CP Car Park Smoke Ventilation System can automatically activate dampers and extract fan to clear smoke from the activated zone. The start of the impulse fans (Induction or Jet) is appropriately delayed (typically 2 mins), to allow people time to evacuate.

The optional Mono Assist mode monitors carbon monoxide levels and if necessary can run impulse fans and extract fans at an appropriate speed to return all levels of the car park to an acceptable pollutant level.

Once installed, the system is fully automatic, but can be controlled by a Schneider manufactured HMI touchscreen interface, for testing and training purposes by authorised users only.

Product Highlights

- Software system – developed by, and exclusive to, Vent Engineering
- On-site training and ongoing support options
- Reduced energy running costs
- Industry leading fans & components
- Reduced ductwork requirements over traditional systems

Technical Data

Ventec 2000-CP Car Park Ventilation System	
Power	Dedicated maintained supply 415Vac / 3-phase / 50 Hz
Smoke Ventilation Option	✓ 10 air changes per hour
Mono Assist Option	✓ 6 air changes per hour
Number Of Zones (Car Park Levels)	Up to 3
Fire Alarm Interface	✓
Fault VFC (Volt Free Contact)	✓

Ventec 2000-CP Components	Necessary	Optional
Fan Control Panel	✓	
HMI Touchscreen Control Panel	✓	
Carbon Monoxide Control Panel		✓
Carbon Monoxide Control Sensors		✓
Extract Fans		✓
Impulse Fans (Induction or Jet)		✓
Smoke Control Damper		✓
Orange Firemans Switch		✓
Positive Pressure Ventilation Unit		✓

Vent Engineering advises that the design, supply, and installation of all electrical wiring be carried out in accordance with current standards.

Car Park Fan Placement Example (indicative only)

Ventec Induct Fans and Jet Fans efficiently move smoke towards the extract fans by drawing air in and re-directing it, with force, to a different area. This entrains the smoke, making it more translucent for firefighter access and reduces its temperature to help limit damage and fire spread. The system design and choice of fan type is based on the car park layout, physical restraints i.e. ceiling height, position of extract fans, occupant escape/access routes and the position of natural air inlets.

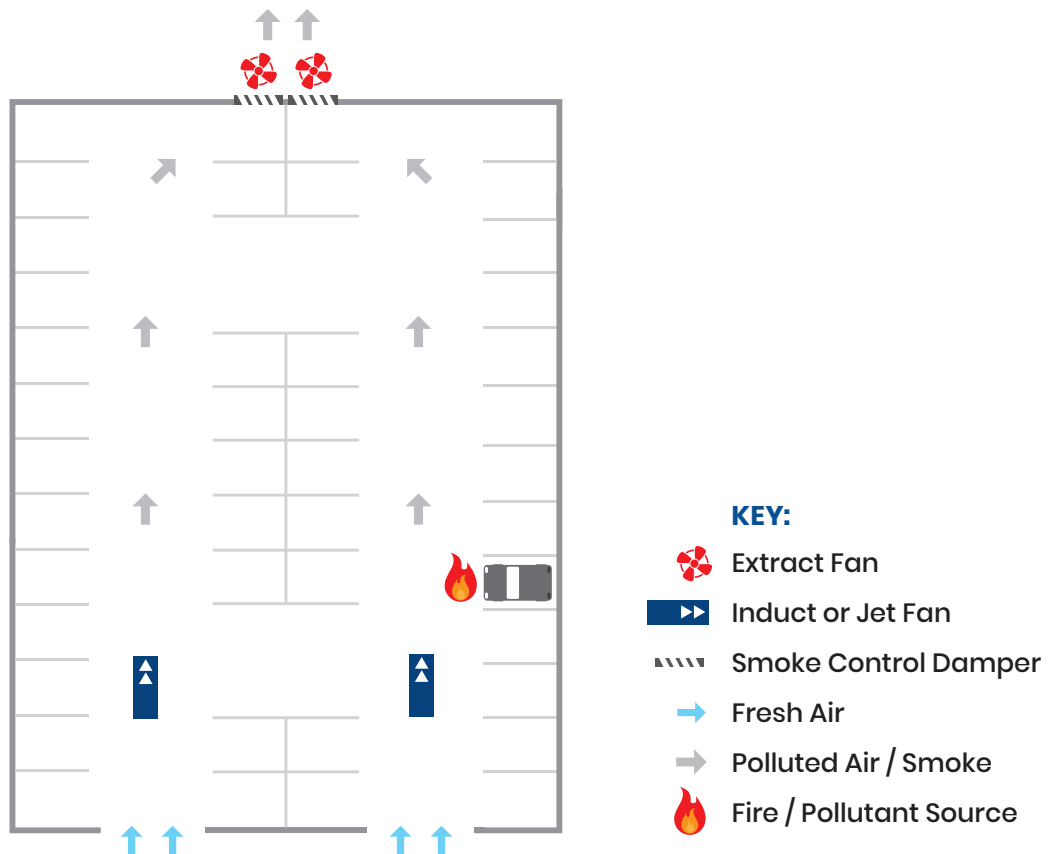

Impulse Ventilation (indicative only)

Section view: Discharge angled to efficiently move air.

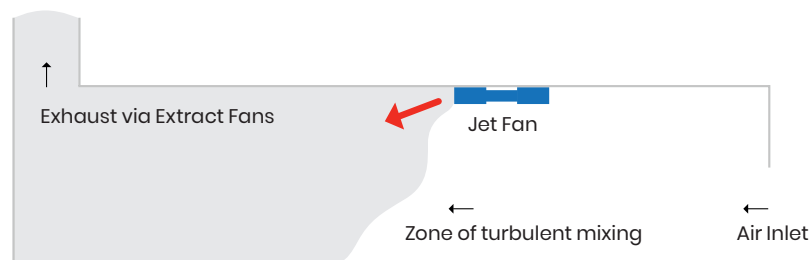

Product Codes

Ventec FCPM	Fan Control Panel (Master)	Bespoke product
Ventec FCPs	Fan Control Panel (Slave)	Bespoke product
Ventec AXF	Axial Fan (Extract Fan)	Bespoke Product
Ventec Induct E50N	Elta Induction Fan	FAEL-IND-050N-0002
Ventec Induct E100N	Elta Induction Fan	FAEL-IND-100N-0002
Ventec Jet 355mm Dia.	Elta Jet Fan	FAEL-CAR-IMPU-0003
Ventec Jet 400mm Dia.	Elta Jet Fan	FAEL-CAR-IMPU-0002
Ventec CM	Carbon Monoxide Sensor	CBPX-PAN-SEN-0001



Regular testing
and record-keeping
by authorised,
responsible persons.



...by “Accredited” and
“certified smoke vent
engineers only”

*REFERENCE:
DAME JUDITH HACKITT REPORT



Minimum Test And Service Intervals As Recommended By Manufacturer

WEEKLY

Continuous 20
minutes running
of smoke system,
including fans.
(80mins per month)

3 MONTHLY

Fan bearing
assessment
by a trained
and certified
engineer.

6 MONTHLY

Maintenance
visit by a
manufacturer
approved
engineer.

Call Vent Engineering to arrange a visit

Related Products and Services

The following should also be considered
when planning your system.



VENTEC 2000-CP
COMPATIBLE



INSTALLATION
& MAINTENANCE



PROJECT
COMMISSIONING