

BATTERY BACKUP SMOKE CONTROL



✓ **NEXT DAY**
DESPATCH

✓ **1 SMOKE**
VENT ZONE

✓ **2 NATURAL**
VENT ZONES

✓ **230V**
POWER INPUT

✓ **24V**
POWER OUTPUT

✓ **4A - 20A**
OPTIONS

About This Product

In the event of a fire, the Ventec 400 CP Control Panel with Battery Backup allows the dispersment of smoke from a single zone. The Ventec 400 Series also allows daily ventilation of up to two zones by opening single or multiple windows or vents.

The control panel is supplied with two 12Vdc 4.5 Ah in series batteries, that are kept charged when the mains power supply is available. When power is unavailable they guarantee a 72 hour period in standby mode allowing the execution of a complete emergency opening command as prescribed by BS EN12101-10.

Multiple units can be linked in series to give an increased output. This expandable capability allows the control of multiple actuators and devices that, when combined, require a larger than standard amount of power to function.

A Ventec OFS 400 Orange Firemans Switch will need to be connected to each panel.

Product Highlights

- 72 hour standby power
- On board LED visual diagnostics

BATTERY BACKUP SMOKE CONTROL

Dimensions

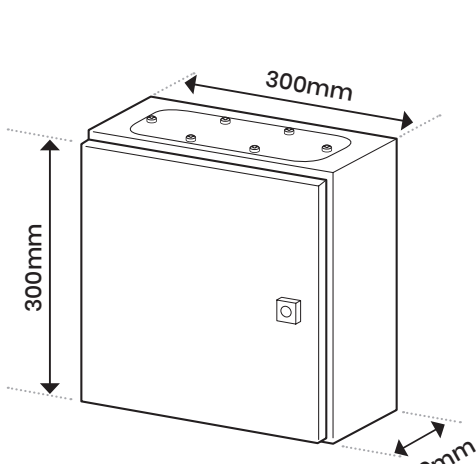

Ventec 400 CP: 404 BBU (4 amps)
Ventec 400 CP: 408 BBU (8 amps)

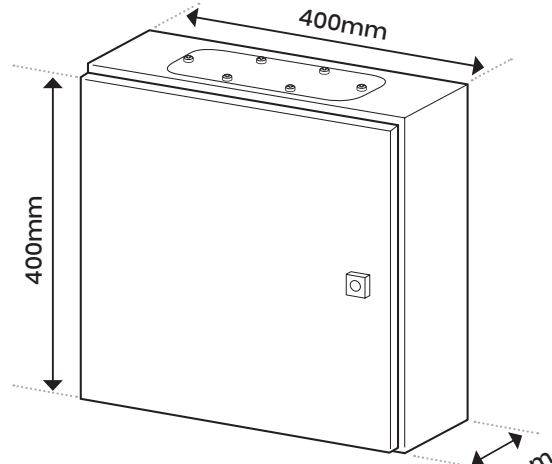

Ventec CP: 420 BBU (20 amps)

Installation Example
(indicative only)

KEY:

- CP** Ventec 400 Control Panel
- AOV** Automatic Opening Vent
- RS** Rain Sensor
- WS** Wind Sensor
- OSD** Optical Smoke Detector
- DS** Retractive Day Switch
- TC** Thermostatic Controller
- CD** Carbon Dioxide Sensor
- OFS** Orange Firemans Switch

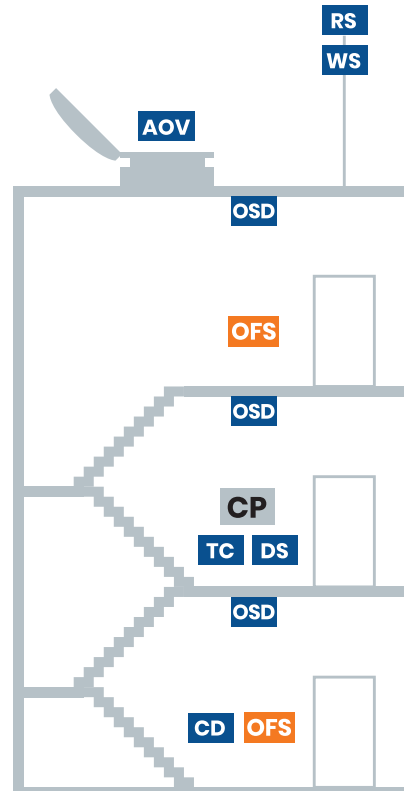

BATTERY BACKUP SMOKE CONTROL

Technical Data

	Ventec 400 CP: 404 BBU	Ventec 400 CP: 408 BBU	Ventec 400 CP: 420 BBU
Operating Voltage	230Vac	230Vac	230Vac
Output Maximum	4 amps	8 amps	20 amps
Width (mm)	300mm	300mm	400mm
Depth (mm)	150mm	150mm	150mm
Height (mm)	300mm	300mm	400mm
Battery Re-charging Time – 0% to 100%	10 hours	10 hours	10 hours
Operating Temperature	-5°C to +40°C	-5°C to +40°C	-5°C to +40°C
Visual Diagnostics – On Board LEDs	GREEN ON: Power supply is on • YELLOW ON: A fault is detected • RED ON: An alarm is active		
Daily Ventilation Zones	1 or 2	1 or 2	1 or 2
Smoke Ventilation Zones	1	1	1

INPUTS

Smoke Detectors Supported	10	10	10
Orange Firemans Switches (OFS) Supported	1 minimum – 10 maximum	1 minimum – 10 maximum	1 minimum – 10 maximum
OFS Input No. Of Cable Cores	7 Core + Earth	7 Core + Earth	7 Core + Earth
Fire Alarm Volt Free Normally Closed Connection	✓	✓	✓
Master OFS (All zones open or closed)	✓	✓	✓
Daily Switch	1 or 2	1 or 2	1 or 2
Thermostat, Wind, Rain and CO ₂ Sensor	✓	✓	✓
Maglock Support – Auxiliary 1 Output	✓	✓	✓

OUTPUTS

2 Motor Outputs 24Vdc	Max. load 2x 2.0 amps	Max. load 2x 4.0 amps	Max. load 2x 10 amps
Visual Display	Min. 1 OFS	Min. 1 OFS	Min. 1 OFS
Expandable Auxiliary Panel	✓	✓	✓
Lift To Ground Option	✓	✓	✓

Vent Engineering advises that the design, supply, and installation of all electrical wiring be carried out in accordance with current standards.

BATTERY BACKUP SMOKE CONTROL

Installation Arrangement (indicative only)



DAILY VENTILATION
Installing a single DS 400 switch allows the daily operation of all actuators connected to the control panel (all open / all closed).

SMOKE VENTILATION

On fire alarm, smoke detector, or fire override switch activation – all zones open as one, and close as one.



DAILY VENTILATION
Installing a second DS 400 switch allows splitting the two actuator outputs into two separate zones allowing each zone to be independently controlled in a daily operation mode. In smoke mode, manual ventilation control from the DS 400 switches is overridden.

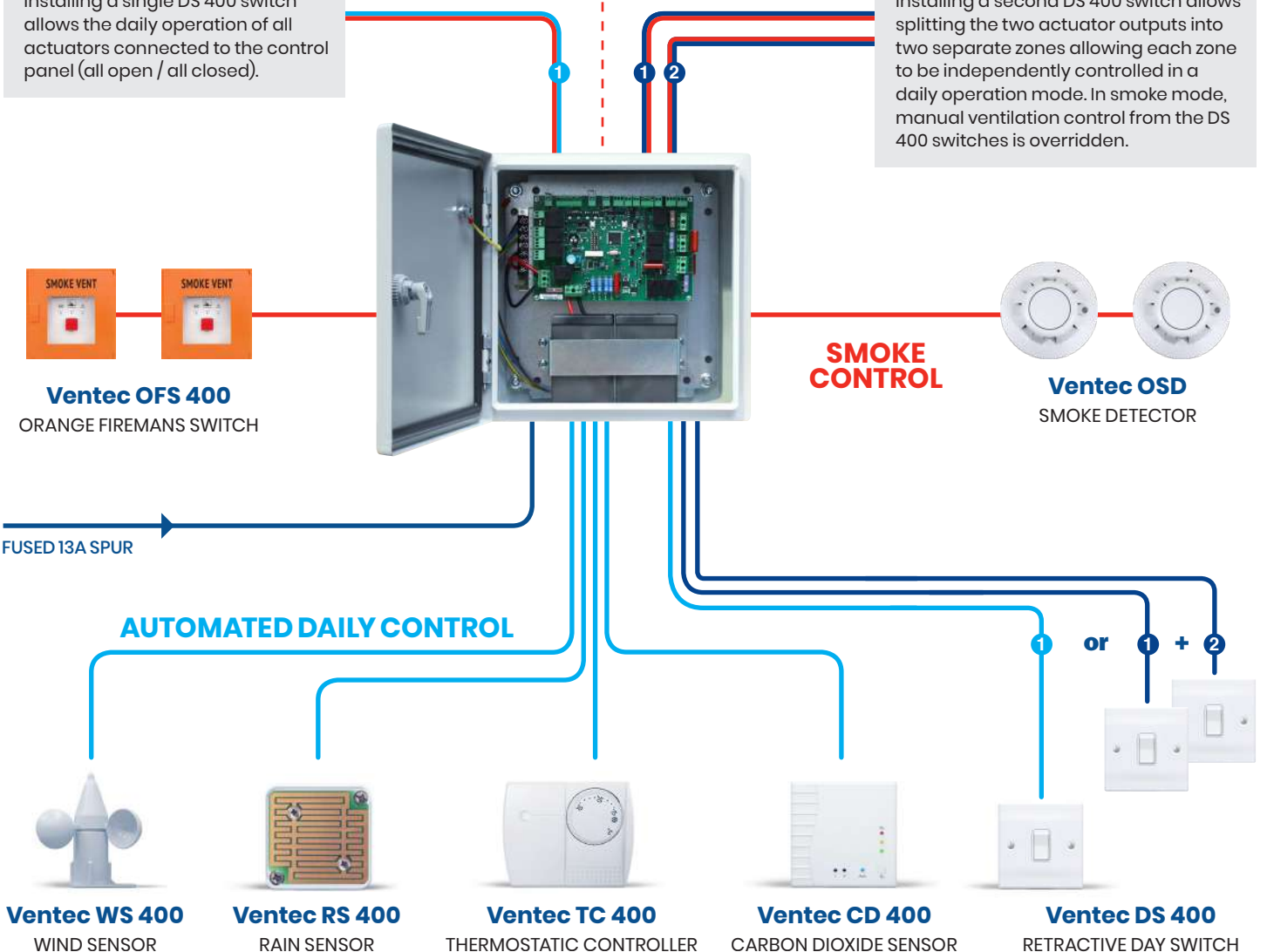

BATTERY BACKUP SMOKE CONTROL

Product Codes

Ventec 400 CP: 404 BBU	4 amps	COSM-SIN-ZONE-0009
Ventec 400 CP: 408 BBU	8 amps	COSM-SIN-ZONE-0016
Ventec 400 CP: 420 BBU	20 amps	COSM-SIN-ZONE-0013



Regular testing and record-keeping by authorised, responsible persons.



...by “Accredited” and “certified smoke vent engineers only”

*REFERENCE:
DAME JUDITH HACKITT REPORT



Related Products and Services

The following should also be considered when planning your system.



400 SERIES
WEATHER STATION



INSTALLATION
& MAINTENANCE



PROJECT
COMMISSIONING